

vtech[®]

User's Manual

Teach & Travel Animal Train™



© 2004 VTECH
Printed in China
91-2456-000 美

Dear Parent,

*At VTech® we know how important the first day of school is for your child. To help prepare preschoolers for this important event, VTech® has developed the **Preschool Learning™** series of interactive toys.*

***Preschool Learning™** features fun characters and inviting school themes that use technology to capture a child's attention and teach important preschool skills like spelling, counting and the alphabet. These vital skills are taught in a way that's both fun and highly engaging to maintain a child's interest. Children will also be introduced to fun school subjects such as art class, music class and even recess! With **Preschool Learning™**, learning is fun from day one!*

At VTech® we know that a child has the ability to do great things. That's why all of our electronic learning products are uniquely designed to develop a child's mind and allow them to learn to the best of their ability. We thank you for trusting VTech® with the important job of helping your child learn and grow!

Sincerely,

Your Friends at VTech®

*To learn more about **Preschool Learning™** and other VTech® toys, visit*

www.vtechkids.com

INTRODUCTION

Thank you for purchasing the **VTech® Teach & Travel Animal Train™**! Toot-toot! Hop on board the animal express! Along this exciting journey, you will learn about animals, where they live, the sounds they make and more! They will also encourage you to explore the alphabet, numbers and music. Are your engines ready? Let's roll!

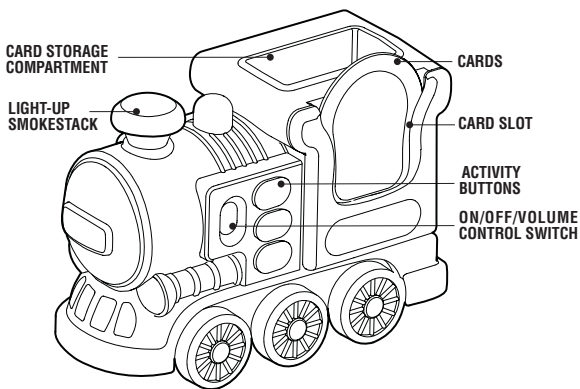

INCLUDED IN THIS PACKAGE

- One **VTech® Teach & Travel Animal Train™**
- Thirteen double-sided animal adventure cards and one double-sided number card
- One instruction manual

WARNING: All packing materials such as tape, plastic sheets, wire ties and tags are not part of this toy, and should be discarded for your child's safety.

GETTING STARTED

BATTERY INSTALLATION

1. Make sure the unit is OFF.
2. Locate the battery cover on the bottom of the unit. Use a screwdriver to open the battery cover.
3. Install 2 new "AA" (UM-3/LR6) batteries into the compartment as illustrated. (The use of new, alkaline batteries is recommended for maximum performance.)
4. Replace the battery cover and make sure it is properly secured.

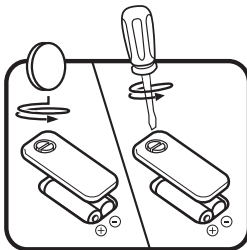

BATTERY NOTICE

- Install batteries correctly observing the polarity (+,-) signs to avoid leakage.
- Do not mix old and new batteries.
- Do not use batteries of different types.
- Remove exhausted or new batteries from the unit when the unit will not be used for an extended period of time.
- Do not dispose of batteries in fire.
- Do not attempt to recharge ordinary batteries.
- The supply terminals are not to be short-circuited.
- Only batteries of the same and equivalent type as recommended are to be used.

WE DO NOT RECOMMEND THE USE OF RECHARGEABLE BATTERIES.

NOTE: Please remove the demo tag, located on the back of the product, after the product is taken out of the package. If the demo tag is still in position when you begin play, please remove it to activate the normal play mode.

PRODUCT FEATURE

1. ON/OFF VOLUME CONTROL SWITCH

Slide the **ON/OFF VOLUME CONTROL SWITCH** to HI or LOW position to turn the learning toy on.

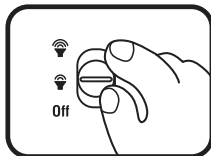

Slide the **ON/OFF VOLUME CONTROL SWITCH** to OFF position to turn the learning toy off.

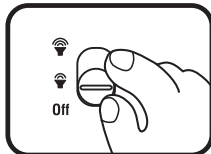

Slide the **ON/OFF VOLUME CONTROL SWITCH** to HI position to choose the higher volume or to LOW to choose the lower volume.

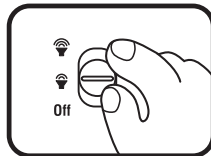

2. ACTIVITY BUTTONS

Press the **ACTIVITY BUTTONS** to choose an activity.



3. CARD SLOT

Insert a card into the slot to hear responses.



4. CARD STORAGE COMPARTMENT

Store the cards in the handy storage compartment.

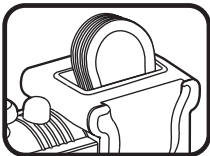

AUTOMATIC SHUT-OFF

To preserve battery life, the **VTech® Teach & Travel Animal Train™** will automatically turn off after several minutes without input. The unit can be turned on again by pressing the **ON/OFF VOLUME CONTROL SWITCH**.

ACTIVITIES

Free Play Mode

1. Slide the **ON/OFF VOLUME CONTROL SWITCH** to HI or LOW position to begin play.

You will be in Free Play mode automatically.

2. Insert a card to learn the letter on that card or animal facts relating to the card.

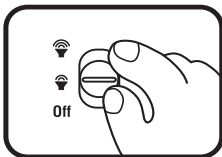

MODE 1: Letters and Numbers



1. Press the **Letters and Numbers Button** to enter this activity.
2. Insert an animal card in the slot to learn the following: Letter of that card, the animal that begins with that letter, and the sound of the animal.
3. Insert the number card to learn counting. For example, you will hear "Five zebras. Let's count to five! One, two, three, four, five!"

MODE 2: Animal Facts



1. Press the **Animal Facts Button** to enter this activity.
2. Insert an animal card in the slot and you will learn animal characteristics, their habitat, the name of their young, the food they eat, and the sounds they make.
3. Insert the number card to learn numbers and hear fun animal sounds.

MODE 3: Quiz



1. Press the **Quiz Button** to enter this activity.
2. You will be asked to find a certain animal. For example, you will hear "Which animal begins with the letter Z?"

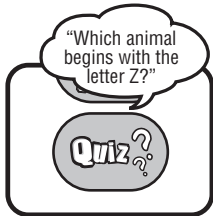
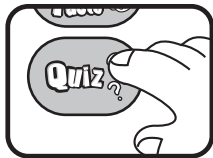

- If a correct animal card is inserted, you will be rewarded with a positive response.
- If an incorrect animal card is inserted, you will be given some hints to help you find the answer.
- If you answer incorrectly three times, the correct answer will be given. Then a new question will be asked.
- There are multiple correct answers to some of the animal fact questions. If one of these questions is asked, the toy will accept any one of several cards as a correct answer on the first try. See the list below for a breakdown of these questions:

Question	Multiple Correct Answers
Which animal lives in a swamp?	Frog
	Iguana
	Newt
	Snake
	Alligator
Which animal lives in the desert?	Camel
	Iguana
	Snake
	Bat
Which animal lives in the ocean?	Dolphin
	Jellyfish
	Urchin
	Whale
	Xiphias
	Turtle
Which animal lives in the grasslands?	Elephant

	Kangaroo
	Lion
	Rabbit
	Zebra
	Horse
Which animal lives in the pond?	Frog
	Iguana
	Snake
	Alligator
	Newt
Which animal lives In the trees?	Monkey
	Quail
	Vulture
	Snake
	Owl
Which animal lives in the woods?	Snake
	Owl
	Porcupine
Which animal has scaly skin?	Alligator
	Snake
Which animal has great hearing?	Rabbit
	Owl
	Bat
Which animal lays eggs?	Alligator
	Urchin
	Frog
	Iguana

	Jellyfish
	Newt
	Owl
	Quail
	Snake
	Turtle
	Goose
Which animal has a blowhole?	Dolphin
	Whale
Which animal has four legs?	Alligator
	Camel
	Elephant
	Frog
	Horse
	Iguana
	Newt
	Porcupine
	Rabbit
	Yak
	Zebra
	Turtle
	Lion
Which animal has webbed feet?	Alligator
	Frog
	Goose
	Iguana
	Turtle

Which animal eats fish?	Newt
	Alligator
	Dolphin
	Jellyfish
	Whale
Which animal eats insects?	Xiphias
	Iguana
	Bat
	Frog
	Goose
	Newt
	Quail
Snake	
Which animal eats plants?	Camel
	Iguana
	Kangaroo
	Porcupine
	Turtle
	Urchin
	Elephant
	Goose
	Horse
	Rabbit
	Yak
	Zebra
	Which animal eats grass?
Rabbit	

	Yak
	Zebra
	Camel
	Goose
	Horse
	Iguana
	Kangaroo
	Porcupine
	Quail
	Turtle
Which animal eats meat?	Lion
	Owl
	Vulture
	Alligator

7. You can enjoy various melodies by inserting the Number Card.

Melody list:

Index	Name
Song 1	Alphabet Song
Song 2	Animal Fair
Song 3	Big Rock Candy Mountains
Song 4	I've Been Working on the Railroad
Song 5	The Entertainer

CARE & MAINTENANCE

1. Keep the unit clean by wiping it with a slightly damp cloth.
2. Keep the unit out of direct sunlight and away from any direct heat source.
3. Remove the batteries when the unit is not in use for an extended period of time.
4. Do not drop the unit onto a hard surface and do not expose the unit to moisture or water.

TROUBLESHOOTING

If for some reason the program/activity stops working, then please follow these steps:

1. Please turn the unit **OFF**.
2. Interrupt the power supply by removing the batteries.
3. Let the unit stand for a few minutes, then replace the batteries.
4. Turn the unit **ON**. The unit will now be ready to play again.
5. If the unit still does not work, replace with an entire set of new batteries.

If the problem persists, please call our Consumer Services Department at 1-800-521-2010 in the U.S. or 1-877-352-8697 in Canada and a service representative will be happy to help you.

IMPORTANT NOTE:

Creating and developing **Preschool Learning™** products is accompanied by a responsibility that we at **VTech®** take very seriously. We make every effort to ensure the accuracy of the information which forms the value of our products. However, errors sometimes can occur. It is important for you to know that we stand behind our products and encourage you to call our Consumer Services Department at 1-800-521-2010 in the U.S. or 1-877-352-8697 in Canada with any problems and/or suggestions that you might have. A service representative will be happy to help you.

NOTE:

This equipment has been tested and found to comply with the limits for a Class B digital device, pursuant to Part 15 of the FCC Rules. These limits are designed to provide reasonable protection against harmful interference in a residential installation. This equipment generates, uses and can radiate radio frequency energy and, if not installed and used in accordance with the instructions, may cause harmful interference to radio communications. However, there is no guarantee that interference will not occur in a particular installation. If this equipment does cause harmful interference to radio or television reception, which can be determined by turning the equipment off and on, the user is encouraged to try to correct the interference by one or more of the following measures:

- Reorient or relocate the receiving antenna
- Increase the separation between the equipment and receiver
- Connect the equipment into an outlet on a circuit different from that to which the receiver is connected
- Consult the dealer or an experienced radio/TV technician for help

NOTE:

This device complies with part 15 of the FCC Rules. Rperation is subject to the following two conditions: (1) this device may not cause harmful interference, and (2) this device must accept any interference received, including interference that may cause undesired operation.

This Class B digital apparatus complies with Canadian ICES-003.
Cet appareil numérique de la classe b est conforme à la norme NMB-003 du Canada.